

The

**Whistle**



**Post**

*Official Newsletter of the*

**Neuse River Valley Model Railroad Club**

**1615 Old Louisburg Rd Raleigh, NC 27604**

**Phone: 919-400-5570**

### **“All Aboard”**

Happy Holidays to one and all. Tis the season to celebrate with family and friends and, of course, to get new trains as gifts.

The final numbers are in and once again we had a successful show this fall. Thank you all who worked hard to make this very important part of our Club's activities a social and fiscal success. Our Club depends on these shows to keep the doors open and the power on. Thank You All.

As a result of a member request, we are going to make a concerted effort to keep the business part of Club operations limited to the monthly Board Meetings and to spend more time during Membership meetings on members, programs, tutorials, and other social-related things. This will be a work in progress, but we will start with a revised agenda for this month's meeting and improve as we go. To help make this possible, we need your help. We need feedback on our progress, we need people to put on programs (or at least suggest them), and we need people to share with us what they are doing on their own layouts. With your help, we can make our meetings more enticing and increase attendance and participation.

The December meeting will end with a video presentation provided by George Lasley, featuring two of his favorite videos. The first is titled “two fives are better than one”. It features two British Black Five class 4-6-0's at speed with 15 or so coaches. The second is O. Winston Link's Christmas Eve recording at Rural Retreat with video added. Make sure you join us.

We received a terrific progress report from the HO layout committee. Lots of progress has been made. There will be updated reports and meeting notices from the committee as they progress. Sounds like they are on the right track.

Just a reminder – save the date – Saturday, January 15<sup>th</sup> – that's our next work/learn day at the Club. We plan on learning to install decoders in DC locomotives and to upgrade the Club fleet. We will also learn and work on couplers and wheel sets on Club rolling stock. AND - I will provide food for a lunch break. Don't miss it.

One last thing – if you know anyone interested in trains, bring them to the Club, introduce them to our group - - - let's build membership.

OK Trains ready to go - - - -ALL ABOARD

**John Spach, President**

## HO Layout Committee Activities

On December 5<sup>th</sup>, a meeting of the HO Committee, open to all members interested in the layout expansion, was held at the Clubhouse. Fifteen members attended in person. Two additional interested members were unable to attend. Ken Howard chaired the meeting and Tom Garren took minutes which are available to all Members on our website.

The purpose of the meeting was to initiate the planning process to facilitate construction of the new layout extension and to allow members to contribute to the planning process and activities. As part of the meeting, specific objectives, time frames, and goals were established and subcommittees were formed and meeting dates set to begin the planning processes.

A number of aims and objectives were agreed upon during discussions:

- The construction should preserve existing operational capability. No major shutdowns.
- The new construction should be focused more on operating than racetrack train running.
- The new addition should have interesting topography and a multiple level track plan.
- Sectional construction should be used for the extension.

A number of possible configurations for the expansion were discussed. The diagram below was selected by vote of those present. This plan provides approximately 155 square feet of floor space for the expansion. Existing modules 1 and 10 will be removed from the existing layout to provide greater space for the new additions. These modules will be saved for possible later use in construction of a travelling layout. The N-scale layout will be moved to the current Lego site.

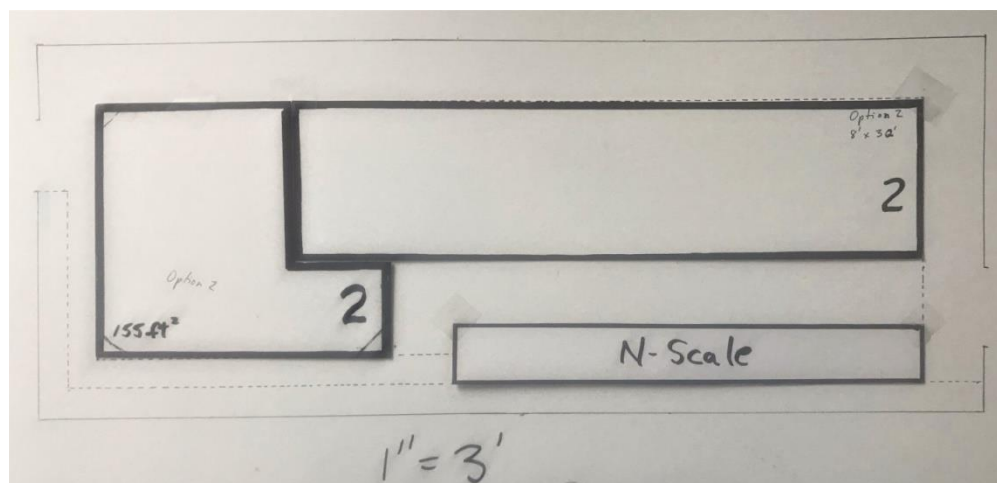

Diagram of the layout room showing the proposed move of the N-scale layout and the floor plan adopted for modification and expansion of the HO layout. The original is displayed on the flip chart easel in the Clubhouse.

A number of other decisions were made during the meeting:

- The HO committee will hold monthly meetings. The next meeting will be January 16<sup>th</sup>, 2022.
- A work session will be held on December 15<sup>th</sup> following the breakfast meeting to begin work on preparation of the layout room and to inventory Club materials that are available for construction. Peter Donofrio, Randy Foulke, and Ken Howard will make the inventory for presentation to the January meeting.
- An additional subcommittee was established to develop options for track plans. The following members volunteered to work on options: Bob Witwer, Peter Donofrio, Brock Bowden, Ethan Quiram, Tom Tieman, and Peter Ring. Their initial report will be presented at the January meeting.

The overall goal of the committee is to be able to present plans and cost estimates for construction to the Board of Governors meeting in early February.

**Ken Howard**

## Neat Links

**Tom Magnani** provided the following links:

**The most useful model railroad in the world.** A Marklin model railroad used by German railroads to teach train control and interlocking.

<https://www.youtube.com/watch?v=6TLcaJdsRr0>

**Editor's note:** The video shows the evolution of train control from mechanical system interlocking through modern computer screen interfaces used to control a model train system. You might get some ideas that could be used on your own or a Club layout. The video runs 9:42 minutes.

**How Gresley's A4 Pacifics became the World's Fastest Steam Engines**

<https://www.youtube.com/watch?v=WTeFc1VgwP4>

**Editor's note:** The video begins with a color video of a passenger train pulled by an A4 at speed but quickly moves into a historical account of the LNER. It will be of considerable interest to fans of British Railways and fast (plus 100 mph) steam locomotives. There are lots of photos of historical steam locomotives and a complete history of the development and integration of the trainsets with the locomotive. The video runs 28:32 minutes.

## Book Review

*Norfolk Southern Color Pictorial 1950's -1970's*

by Dalton P. "Billy" McDonald

Tom Garren

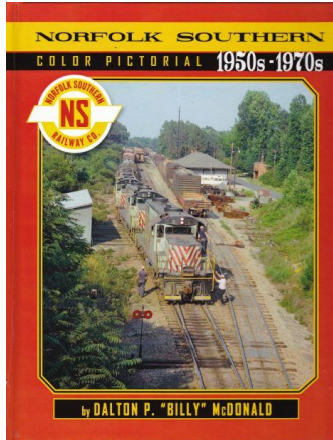

For any fan of the original Norfolk Southern Railway, this book is a must have. It is organized geographically from Norfolk to Charlotte by division and branches. It has a nice section on Glenwood Yard and Boylan tower. The book provides color photos of the locomotives used during this time period. This includes two different red schemes on the Baldwins, and the gray scheme used on the GP18s, GP38s and Baldwins. The GE 70 tonners are also shown in both red and gray paint schemes.

It is interesting to see the line from end to end as it was fifty or more years ago. Today some of these areas have been abandoned or sold off to short lines.

The book was first published in 2015 and was available in small numbers. This has led to very high prices on the used book market, such as \$200.00 on eBay.

The Norfolk Southern Historical Society is offering a reprint of the book at the original price of \$55.00 plus shipping. Per information in the book, there are only 100 copies of the reprinted edition. I was very pleased to buy a copy at our November show.

Additionally the Historical Society has also reprinted the book *The Original Norfolk Southern Railway 1883-1974*. This book presents the history of the railroad. It was first published in 2007 and has been unavailable for years. It typically goes for \$300.00 on eBay. This reprint is also available for \$55.00 plus shipping.

If you would like to obtain your own copy of either of these books, they can be ordered from the Norfolk Southern Historical Society's website at <http://www.norfolksouthernhs.org>.

## Club COVID-19 Mask Policy

Although some Triangle cities have eliminated their mask requirements, the Club will continue to honor the City of Raleigh mandate. A mask or face covering is required while you are inside the Clubhouse regardless of your vaccination status. Thank you for your cooperation.



## Open Houses and Member's Layouts

On December 8<sup>th</sup> a rare encounter took place in Virginia. Four, two-rail O- scale, VGN class AE 800s (2-10-10-2), gathered for a photo opportunity on Joe Scales layout. The rare occurrence was photographed by George Lasley.



**Merry Christmas from Fred Krauss via Tom Magnani.**



In case you haven't set up your own layout for the Season, here's a possible solution.

### **Railroad Slang Contest (courtesy of John Spach)**

Test your train trivia knowledge with this 10 part challenge match up. Match the term with the appropriate definition. Answers can be found on Page 9.

- |                    |                                    |
|--------------------|------------------------------------|
| 1. Bake a cake     | a. caboose                         |
| 2. Big shot        | b. emergency application of brakes |
| 3. Clown wagon     | c. tool box under caboose          |
| 4. Eagle eye       | d. lunch bucket                    |
| 5. Ground hog      | e. temporary track                 |
| 6. Jerry gang      | f. build up steam                  |
| 7. nosebag         | g. switchman                       |
| 8. possum belly    | h. engineer                        |
| 9. shoofly         | i. section crew                    |
| 10. wipe the clock | j. yardmaster                      |



## Real Train Photos

**George Lasley** has received a number of pictures from **Will Allen's** recent trip to South Africa. If you liked last month's photos of the Rockville Bridge, here's a scenic shot of the Luxury Train crossing the bridge over the Sable River near Skukuza, South Africa.



## Future Events

### Bring your layout to the train show

December 18-19, 2021– Greenberg's Train & Toy Show – Chantilly, VA - Dulles Expo

The link is: <https://www.trainshow.com/bring-a-layout>

## Upcoming Meetings and Activities

December Membership Meeting: The December Membership meeting will be held Thursday, December 16<sup>th</sup>, 7:00 pm at the Clubhouse. Attendance via Zoom is optional.

January Board of Governors Meeting: The January Board of Governors meeting will be held Monday, January 3<sup>rd</sup>, 7:00 pm at the Clubhouse. Attendance via Zoom is optional.

Breakfast Social: Every Wednesday, 9:00 am at Barry's Café, Raleigh, NC.

Dates are set for the **NRV SPRING INTO TRAINS**, 2022 edition. George Lasley has booked the Fairgrounds for April 30 – May 1, so mark your calendars. Date has been moved a week earlier than usual to avoid Mother's Day.

The Clubhouse is open to friends and guests most Saturdays, and Sundays from 10:00 am to 2:00 pm. If you don't have a key, check out our website at: <http://www.nrvclub.net> to see when the Club will be open and call 919-400-5570 to be sure that the doors are open.

## Notes from the Editor and Webmaster

Please send recent photos of Club activities to Bernie Dawson, at [nrvwebmaster@gmail.com](mailto:nrvwebmaster@gmail.com), so he can maintain and update our website.

Thanks to all who are contributing items for the Whistle Post. Your participation is appreciated, and your contributions will appear as space permits. Please send articles, photos of real trains, book reviews, product reviews, photographs of your home layouts, and interesting links to Ken Howard, Whistle Post Editor, at [klhowardjr@aol.com](mailto:klhowardjr@aol.com).

**Answers to Railroad Slang Matching Game: 1-f, 2-j, 3-a, 4-h, 5-g, 6-i, 7-d, 8-c, 9-e, 10-b**

**How Did You Do?**

## Minutes of the Membership, Board, and Committee Meetings

Minutes of both Board of Governors and Membership meetings are now available to those who wish to read them on the Club website. Also, minutes from HO Committee meetings are now available, so members can follow the planning and construction of the new HO layout additions. The link below takes you directly to the Minutes page:

<https://nrvclub.net/meeting-minutes/>



NRV Whistle Post  
The Neuse River Valley Model Railroad Club, Inc.  
1615 Old Louisburg Road  
PO Box 19573  
Raleigh, NC 27619-9573

First Class

### BOARD OF GOVERNORS

John Spach	President	<a href="mailto:jtspach@earthlink.net">jtspach@earthlink.net</a>	937-215-2723
Wayne Aiken	Vice-President	<a href="mailto:htomc42@hotmail.com">htomc42@hotmail.com</a>	919-602-8529
Michael Keelean	Treasurer	<a href="mailto:keeleamike@gmail.com">keeleamike@gmail.com</a>	919-886-9238
Tom Garren	Secretary	<a href="mailto:tomgar@mindspring.com">tomgar@mindspring.com</a>	919-805-0909
Calfee (Richard Calfee)	At-Large	<a href="mailto:rhcalfee@yahoo.com">rhcalfee@yahoo.com</a>	301-335-1054
Ken Howard	At-Large	<a href="mailto:klhowardjr@aol.com">klhowardjr@aol.com</a>	919-851-3805
Bob Witwer	At-Large	<a href="mailto:bobwitwer@gmail.com">bobwitwer@gmail.com</a>	919-632-0785

### OTHER KEY POSITIONS

George Lasley	Show Grand Poobah	<a href="mailto:glasley@bellsouth.net">glasley@bellsouth.net</a>	919-757-4503
Calfee (Richard Calfee)	Membership Chair	<a href="mailto:rhcalfee@yahoo.com">rhcalfee@yahoo.com</a>	301-335-1054
Ted Kunstling	Social Media Chair	<a href="mailto:trkunstling@aol.com">trkunstling@aol.com</a>	919-787-5282
Tom Garren	Librarian	<a href="mailto:tomgar@mindspring.com">tomgar@mindspring.com</a>	919-805-0909
George Lasley	Historian	<a href="mailto:glasley@bellsouth.net">glasley@bellsouth.net</a>	919-757-4503
Ken Howard	Newsletter Editor	<a href="mailto:klhowardjr@aol.com">klhowardjr@aol.com</a>	919-851-3805

**WEB SITE** [www.nrvclub.net](http://www.nrvclub.net)

Bernie Dawson	Webmaster	<a href="mailto:nrvwebmaster@gmail.com">nrvwebmaster@gmail.com</a>	919-275-2144
---------------	-----------	--	--------------